

ZBRRA

Programmable receiver - 2 relays - 24..240 V
AC/DC - 2 pusbuttons - 6 LEDs



Main

Range of product	Harmony
Product or component type	Programmable receiver
Device short name	ZBRRA
Output type	2 relays
Product specific application	Interface to actuators
Function of module	Monostable Bi-stable Stop/Start
Reset time	2 ms (time delay)

Complementary

Switching capacity in VA	1250 VA
Maximum switching current	5 A AC/DC
[Us] rated supply voltage	24...240 V AC/DC 50/60 Hz - 10...10 %
Utilisation category	AC-15 : B300 conforming to IEC 60947-5-1 DC-12 conforming to IEC 60947-5-1
Power consumption in W	<= 4 W AC/DC
Immunity to microbreaks	10 ms
Control circuit frequency	50...60 Hz +/- 10 %
Width	35 mm
Output contacts	2 C/O
Nominal output current	3 A
Operating position	Any position without derating
Electrical connection	1 conductor cable 0.14...2.5 mm ² - AWG26...AWG14 - solid - without cable end conforming to IEC 60947-1 2 conductors cable 0.14...1.5 mm ² - AWG26...AWG16 - solid - without cable end conforming to IEC 60947-1 1 conductor cable 0.14...4 mm ² - AWG26...AWG12 - flexible - with cable end conforming to IEC 60947-1 2 conductors cable 0.14...1.5 mm ² - AWG26...AWG16 - flexible - with cable end conforming to IEC 60947-1
Tightening torque	0.5...1 N.m conforming to IEC 60947-1
Housing material	Self-extinguishing plastic
Status LED	1 LED green for power ON 2 LEDs green for relay ON 2 LEDs green for function mode 1 LED green and yellow for reception signal
Mounting support	35 mm symmetrical DIN rail conforming to EN/IEC 60715

The information provided in this documentation contains general descriptions and/or technical characteristics of the products of the company Schneider Electric. This information is not intended to be used for determining suitability or reliability of these products for specific user applications. It is the duty of any user or integrator to perform the appropriate and complete risk analysis, evaluation and testing of the products with respect to the relevant specific application or use thereof. Neither Schneider Electric Industries SAS nor any of its affiliates or subsidiaries shall be responsible or liable for misuse of the information contained herein.

Environment

Standards	IEC 6100-4-2 IEC 6100-4-3 IEC 6100-4-4 IEC 6100-4-5 IEC 6100-4-6 IEC 6100-4-11
Product certifications	CSA C-Tick GOST UL ANATEL SRRC
Marking	CE
Ambient air temperature for storage	-40...70 °C
Ambient air temperature for operation	-25...55 °C
Relative humidity	90 % at 55 °C
Vibration resistance	+/- 6.2 mm (f= 5...11 Hz) conforming to IEC 60068-2-6 3 gn (f= 11...150 Hz) conforming to IEC 60068-2-6
Shock resistance	30 gn (duration = 11 ms) conforming to IEC 60068-2-27
IP degree of protection	IP20 on casing conforming to IEC 60529 IP20 on terminals
Pollution degree	2 conforming to IEC 60664-1
Overvoltage category	II conforming to IEC 60664-1
Insulation resistance	> 500 MOhm at 500 V DC conforming to NF C 20030
[Ui] rated insulation voltage	250 V conforming to IEC 60664-1
Electromagnetic compatibility	Conducted emission conforming conforming to EN/IEC 61000-6-2 Radiated emission conforming
Resistance to electrostatic discharge	8 kV in free air (in insulating parts) conforming to IEC 61000-4-2 6 kV on contact (on metal parts) conforming to IEC 61000-4-2
Resistance to electromagnetic fields	10 V/m, f = 80...2000 MHz conforming to IEC 60947-5-1 3 V/m, f = 80...2700 MHz, distance = 20 m conforming to IEC 60947-4-3
Resistance to fast transients	2 kV
Electrical durability	100000 cycles
Mechanical durability	1000000 cycles

Programmable Receiver

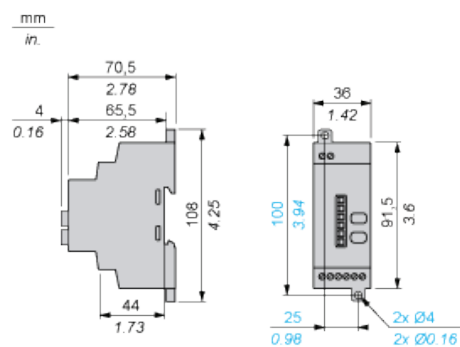

Receiver Clearance

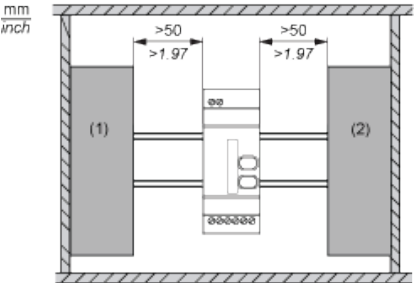

- (1) Drive
- (2) Power Supply or PLC

Receiver Mounting

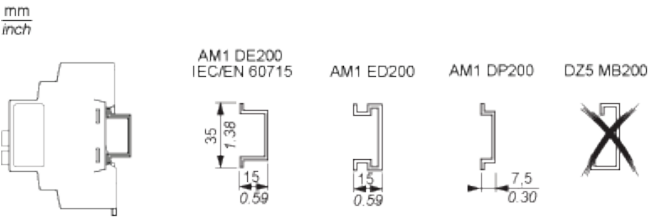

Programmable Receiver

Wiring Diagram

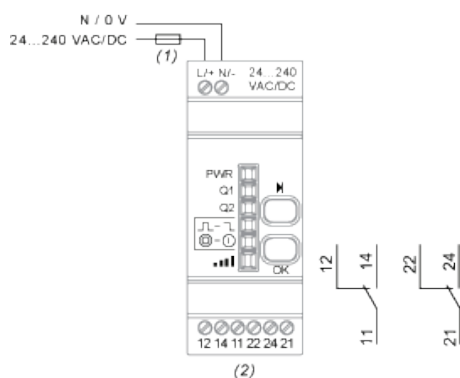

- (1) 400 mA fast-blow fuse
- (2) $I_{max} = 3\text{ A}$