

PROVENT SERIES



FEATURES

The ProVent Series is a very compact ducted in-line fan that is designed specifically for exhaust and supply applications in apartments, hotels and homes etc., as well as room to room hot and cold air transfer systems.

Its powerful mixed-flow impeller provides reliable air flow performance.

Construction

Casings are made of reinforced injection moulded polypropylene plastic. All units are provided with an integral mounting foot. Impellers are of injection moulded plastic and of mixed-flow design.

Motors

Type - RIL-100 and RIL-125: 2-speed, shaded pole.

RIL-150 and RIL-200: 2-speed, squirrel cage induction.

RIL-150T and RIL-200T: Single-speed, squirrel cage induction.

Electricity supply - 220-240V, single-phase, 50Hz.

Bearings - sleeve for models RIL-100 and RIL-125, and ball for all other models.

Speed-controllable using VA type speed controller in high speed only. Not applicable to models with run-on timer.

Internal Thermal Protection

By fuse for models RIL-100 and RIL-125 and for all other models manual-reset thermal overload protection device in accordance with mandatory requirement for in-duct fans AS/NZS60335-2-80:2004

Testing

Air flow to ISO5801:1997

Noise to BS848:Part 2, 1985

Special Note

Avoid the use of spring-loaded backdraft dampers, extensive lengths of duct and air valves with the RIL-100 and RIL-125 models.

Special Features

The fan can be removed easily without disturbing the connecting ductwork via specially designed support brackets.







Models without run-on timer are fitted with plug and lead.

Please note that timer models don't include plug and lead, and are not speed controllable.

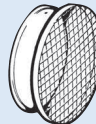
Multi-stage fans

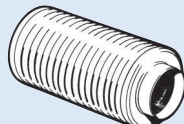
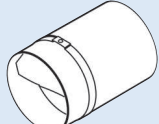
In addition to being used as single-stage fans the ProVent range can be arranged in parallel, in series or in both parallel and series. Such flexibility enables higher air flow and pressure demands to be met. Details for 2-stage parallel are shown over-page.

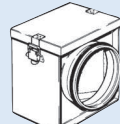
ANCILLARY EQUIPMENT

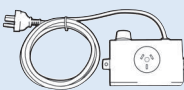
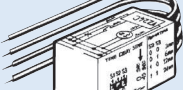
 MRJ - Inlet grille Ref. B-9*	 RED - Reducer* Ref. B-9*	 TSS1 - 2-Speed switch Ref. B-9*†
 CC - Attenuators Ref. H-3*	 SJK - Backdraft Damper Ref. J-3*	 RSK - Backdraft Dampers Ref. J-3*
 FC - Fast clamp Ref. J-5*	 FGR - Filter Unit Ref. J-10*	 VA - Speed controller Ref. L-6*†
 Plug-In Run-on Timer and Speed Controller Ref. L-7*†	 VZ - Run-on timer Ref. L-10*†	

* Fans by Fantech catalogue page

† Not suitable for models RIL-150T and RIL-200T

TECHNICAL DATA

Model Number	Fan Speed rev/sec	Avg. dB(A) @ 3m	RIL.. 1 ph. Watts Amps		Max. amb °C	App. wt. kg
100	36 / 31	42 / 33	24 / 18	0.11 / 0.10	40	2.0
125	37 / 32	43 / 40	30 / 22	0.13 / 0.10	40	2.0
150	42 / 33	47 / 39	50 / 44	0.22 / 0.19	60	2.7
150T	42	47	50	0.22	60	2.7
200	42 / 33	53 / 45	120 / 100	0.50 / 0.45	60	4.9
200T	42	53	120	0.50	60	4.9

Values shown are High Speed / Low Speed for models RIL-100, RIL-125, RIL-150 and RIL-200.

HOW TO ORDER

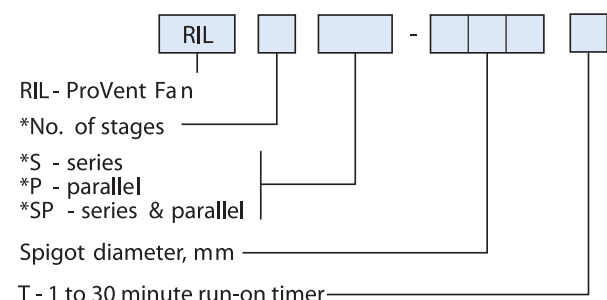

* Only required if other than standard single-stage unit.

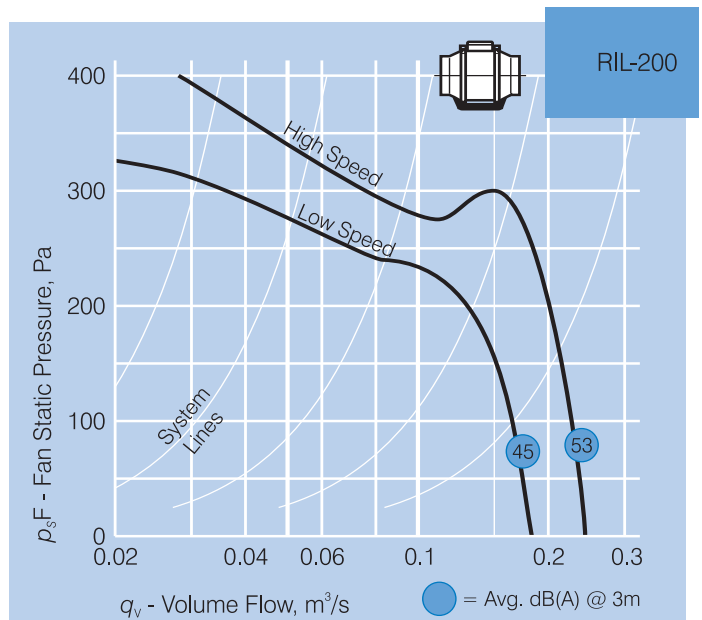
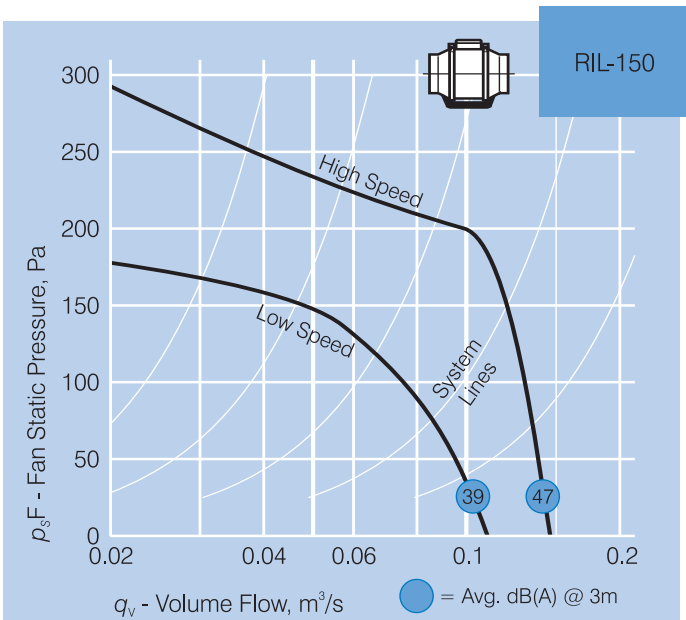
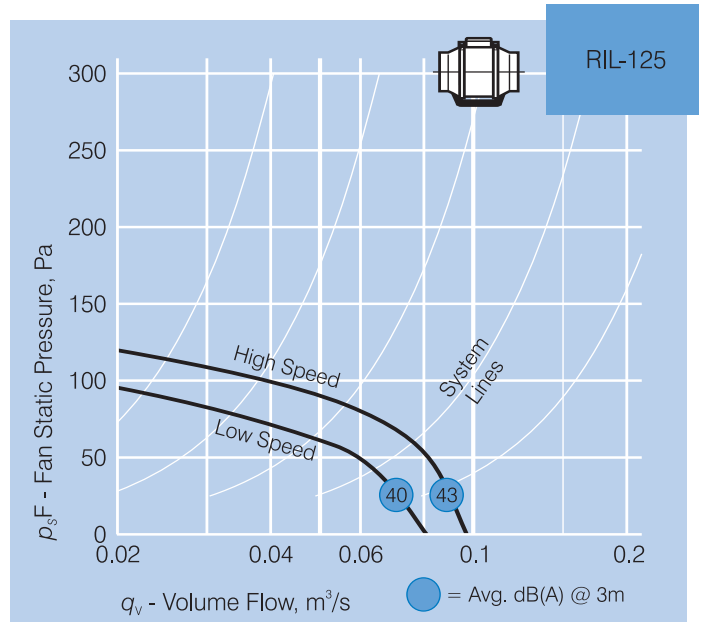
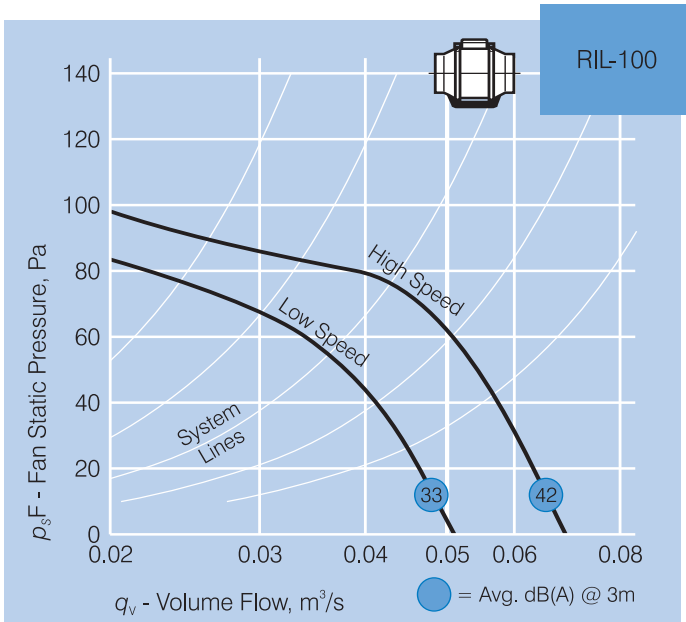

NOISE DATA

Model Number	Avg. dB(A) @ 3m	In-duct Sound Power Levels						
		L_w dB re 1pW	125	250	500	1k	2k	4k
RIL-100	42	53	57	60	59	54	48	41
RIL-125	43	53	58	61	60	55	49	42
RIL-150	47	56	64	65	62	61	53	46
RIL-200	53	60	64	73	66	67	62	55

Sound Power Levels shown are based on the high speed for each fan.

DIMENSIONS

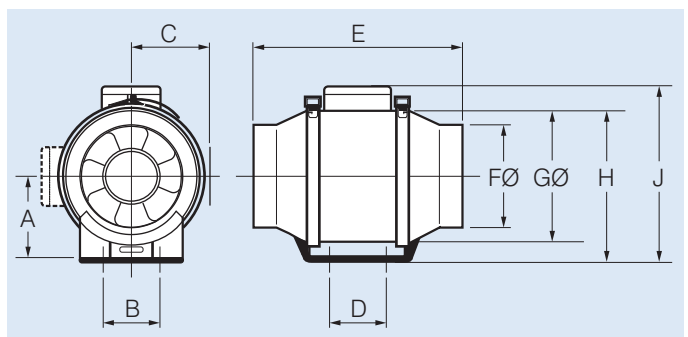

Model Number	Dimensions, mm								
	A	B	C	D	E	FØ	GØ	H	J
RIL-100	100	60	115	80	303	97	176	190	220
RIL-125	100	60	115	80	258	123	176	190	210
RIL-150	112	60	100	80	295	147	200	225	236
RIL-200	124	94	109	100	302	198	217	235	265

FANS IN PARALLEL

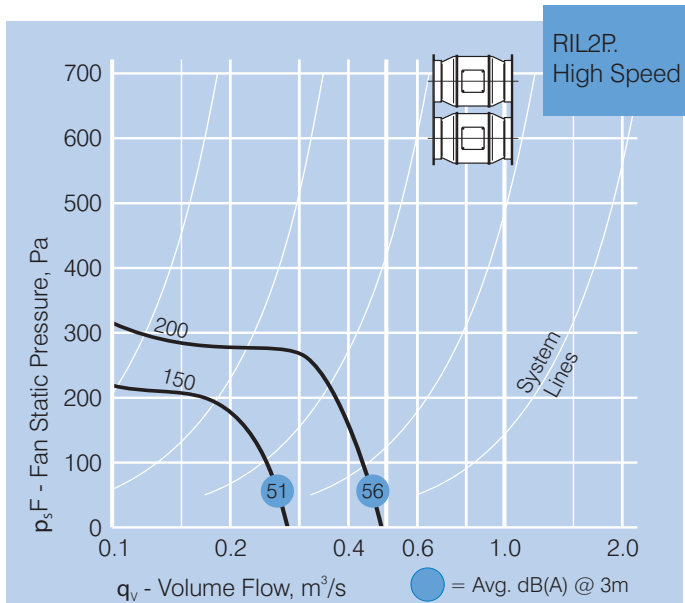

Noise Data

Model Number	Avg. dB(A) @ 3m	In-duct Sound Power Levels L_w dB re 1pW						
		125	250	500	1k	2k	4k	8k
150	51	58	68	69	67	66	59	51
200	56	65	68	75	71	70	66	58

The above curves relate to the performance of 2-fans in parallel.

Dimensions

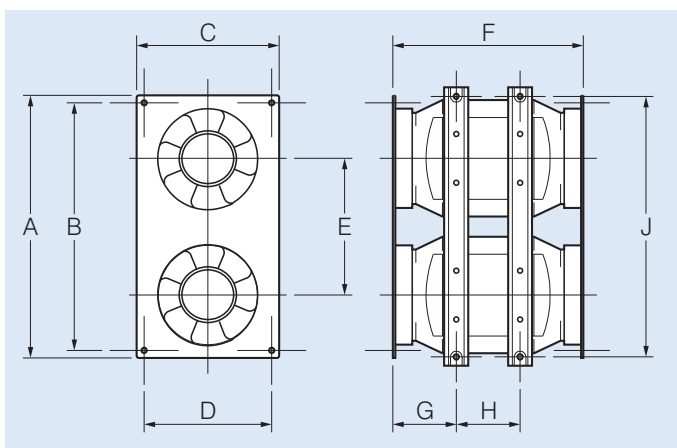

Model Number	Dimensions, mm								
	A	B	C	D	E	F	G	H	J
150	395	375	220	200	206	310	110	80	417
250	540	520	290	270	282	401	123	145	566

We recommend fitting 2 off MCA shutters in parallel assemblies to eliminate short circuiting; these are not included in the dimensions shown.