

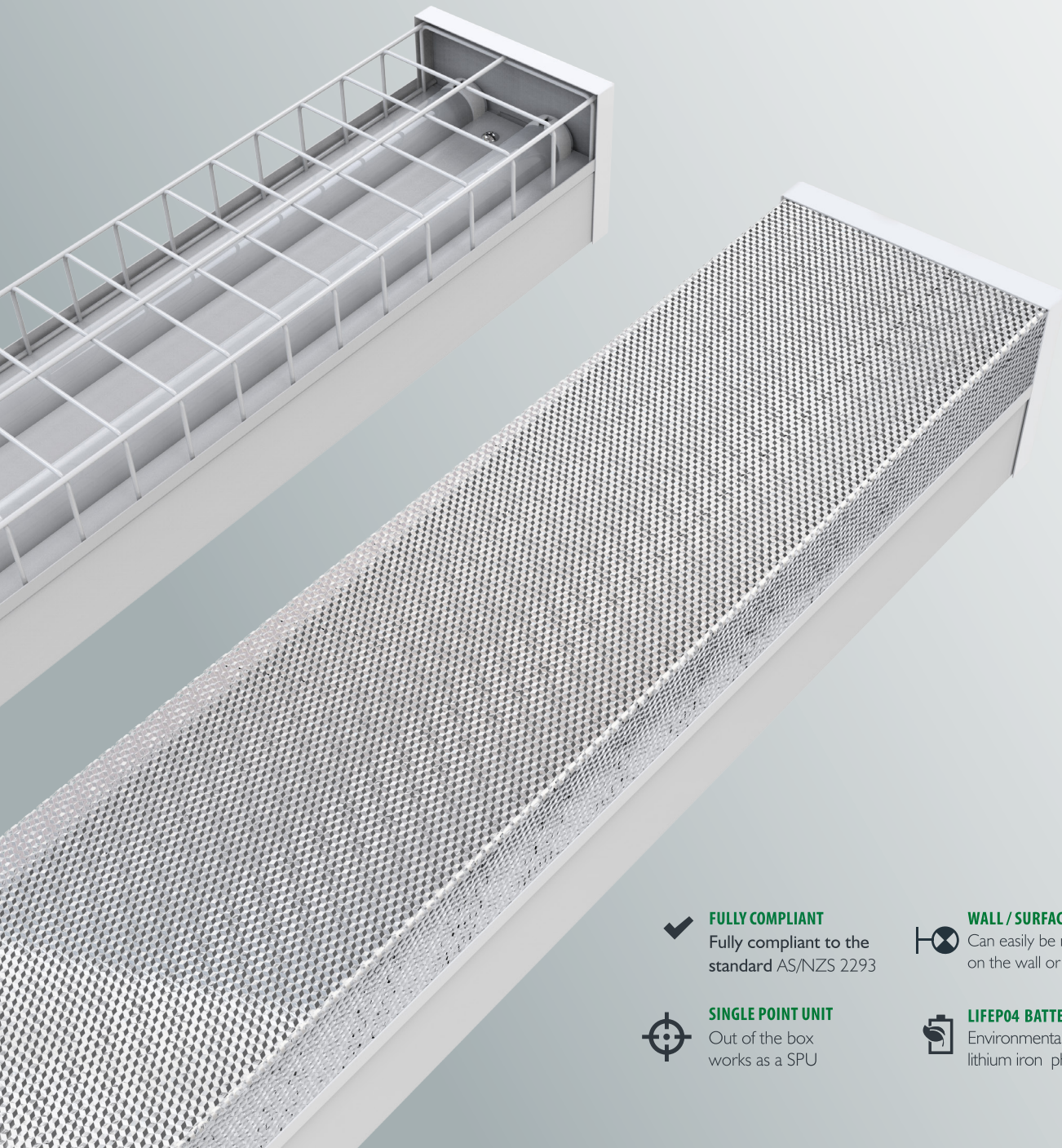

# CLAYMORE LITE

## LED EMERGENCY WIDE BODY BATTENS



### FULLY COMPLIANT

Fully compliant to the standard AS/NZS 2293



### WALL / SURFACE MOUNT

Can easily be mounted on the wall or ceiling



### SINGLE POINT UNIT

Out of the box works as a SPU



### LIFEPO4 BATTERY

Environmentally friendly lithium iron phosphate battery

## ORDERING INFORMATION

SKU	PRODUCT CODE	DESCRIPTION	PRODUCT NO.	CARTON QTY
11277	EV-21W-DIFF-LED-EM-LITE	Claymore Lite 21W Twin 600mm LED Emergency Diffused wide body batten	9336462112779	4
11310	EV-42W-DIFF-LED-EM-LITE	Claymore Lite 42W Twin 1200mm LED Emergency Diffused wide body batten	9336462113103	4
13132	EV-21W-WG-LED-EM-LITE	Claymore Lite 21W Twin 600mm LED Emergency Wireguard wide body batten	9336462131329	4
13101	EV-42W-WG-LED-EM-LITE	Claymore Lite 42W Twin 1200mm LED Emergency Wireguard wide body batten	9336462131015	4

## OPERATIONAL INFORMATION

GENERAL				BATTERY	
Voltage	~220-240V	Mounting type	Surface mounted (wall and ceiling)	Battery type	LiFePO4
Frequency	50Hz	Wiring	Terminal block	Battery voltage	6.4 V
Ambient temp.	0 - 40°C	Emergency class	C <sub>0</sub> :D50, C <sub>90</sub> :D20 (2hr 600mm)	Battery codes	01302 (600mm), 01303 (1200mm)
Class	I		C <sub>0</sub> :D80, C <sub>90</sub> :D40 (2hr 1200mm)	Charging time	16 hours
Duration	90 / 120 min	Colour temp.	4000K	Charger time	Variable
IP rating	IP20				

## CONSTRUCTION AND DIMENSIONS

<b>BODY</b>	Powder coated steel	<b>DIFFUSER</b>	Acrylic
<b>GEAR TRAY</b>	Powder coated steel	<b>WIREGUARD</b>	Powder coated steel

**CLAYMORE BATTEN 21W**

124 mm      620 mm      92 mm

**CLAYMORE BATTEN 42W**

124 mm      1230 mm      92 mm

## ACCESSORIES AND SPARE PARTS

SKU	ORDER CODE	DESCRIPTION
01302	EV-1500MAH-6.4V-LIFEP04	1500mAh 6.4V 2 Cell LiFePO4 Battery
01303	EV-3000MAH-6.4V-LIFEP04	3000mAh 6.4V 2 Cell LiFePO4 Battery
11142	EV-LED-FIRE-BOOST-LITE	Ledfire Boost Lite Emergency Driver
15170	ZC-MW-BATTEN	Microwave sensor 12m, batten kit, IP65 Mains rated batten/floodlight microwave sensor