

#356312 Ultrablade Pro Adapter Plate

Multipurpose 515mm x 160mm white adaptor plate to be used when installing an Ultrablade PRO to replace an existing luminaire, when the ceiling cut-out is a larger size than required. To be used in conjunction with the Ultrablade PRO Instruction Sheet.



1. Spring Toggle Screw
2. Existing Ceiling or Tile
3. Ultrablade PRO Adaptor Plate
4. Ultrablade PRO (Not included)

MOUNTING INSTRUCTIONS

1. Mark & Drill 2 x 10mm holes into Ceiling Tile
Note: Use Ultrablade PRO Adaptor plate to mark holes

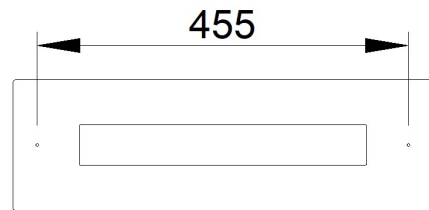

2. Attach Spring Toggle Screws to the Ultrablade Adaptor Plate

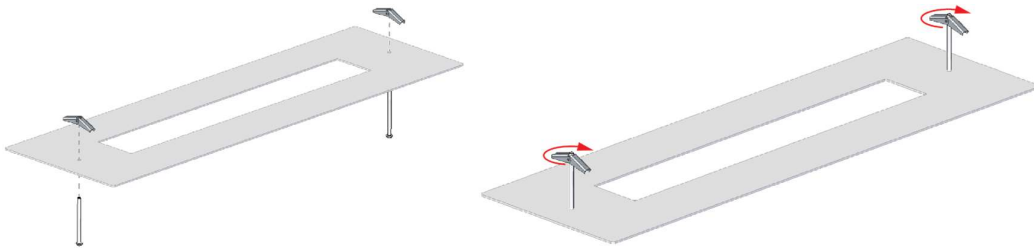

Tighten Spring Toggle until it has just threaded onto screw

3. Mount the Ultrablade Adaptor Plate to the Ceiling

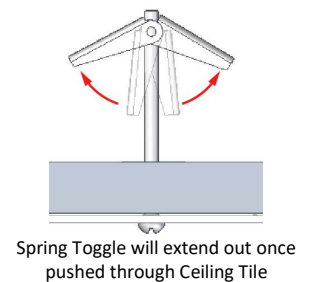
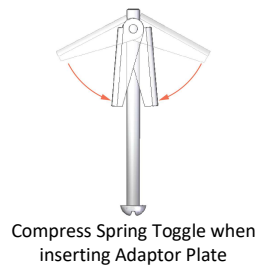
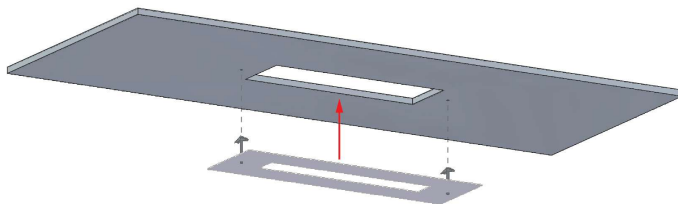



4. Tighten Spring Toggle Screws to secure Ultrablade Adaptor Plate

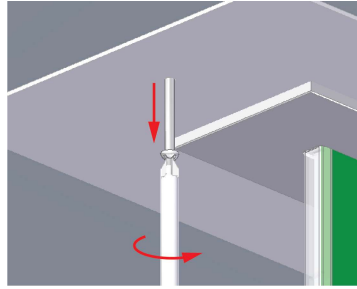
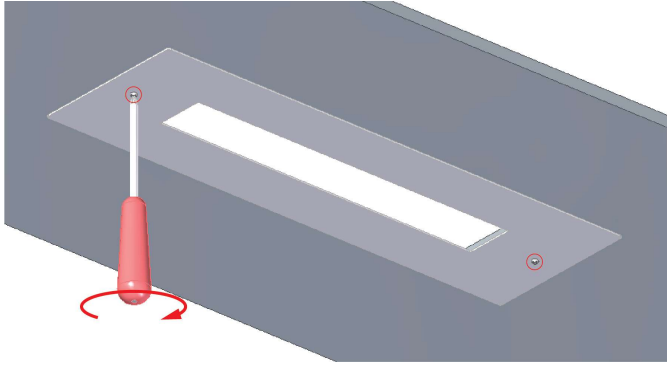

Pull down on screw whilst tightening to stop the Spring Toggle from spinning

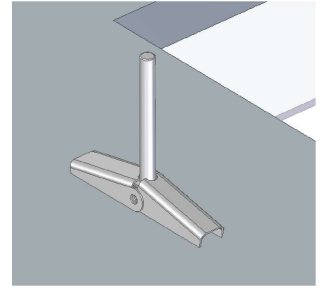

Ensure Spring Toggle is firmly secure into Ceiling Tile

5. Install Ultrablade PRO as per standard installation

Note: Refer to Ultrablade PRO Instruction Guide with product

