

Heavy Duty Copper Lugs

Long Palm & Long Barrel

This innovative new range of copper lugs have been designed for use in the most hazardous and severe fault current applications. Designed and developed in conjunction with a leading electrical distribution organisation who had identified the need for a more robust connector for a number of outdoor and indoor applications.

The lugs are designed for total air-tight cable applications. The barrels are internally sealed at the palm junction and the inspection window is not present.

The lugs use standard dies and tooling but adopt an innovative approach to the increased wall thickness. Each size of lug uses the nominal bore of a standard lug i.e. 35mm sq, but the wall thickness of the next size up the range i.e. 50mm sq. This enables the use of the larger die, in this e.g. a 50mm² die would be used (Cat No. HT130-C-50).

The lugs can easily be modified to any combination of palm style and type, by bending the palm, cropping the palm and the number and size of stud holes. To help us understand your requirements, please contact our Sales Team.

Catalogue No.	Nominal Cable (mm ²)	I.D.	Dimensions (mm)					Crimp Die	A/F Hex Die (mm)	No. of Crimps
			A	B	C	D	E			
CAL25LPBHD	25	7.1	95	16	4.1	61	29	HT130-C-35	9.2	2
CAL35LPBHD	35	8.2	112	18	4.6	72	35	HT130-C-50	10.4	2
CAL50LPBHD	50	9.5	130	18	5.2	80	44	HT130-C-70	11.5	2
CAL70LPBHD	70	11.2	154	21	6.2	100	48	HT130-C-95	14.2	2
CAL95LPBHD	95	13.4	161	25	7.2	100	54	HT130-C-120	16.5	3
CAL120LPBHD	120	15.6	168	28	6.9	100	60	HT130-C-150	18.3	3
CAL150LPBHD	150	16.7	169	32	7.5	100	60	HT130-C-185	20.0	4
CAL185LPBHD	185	18.4	174	35	10.2	100	64	HT130-C-240	23.1	4



Technical Data

Conductive Material

Copper	99.95% pure
Oxygen Content	30 ppm max
Tensile Strength	200 MPa
Ductile Rating	40%
Final Metal State	Fully Annealed

Operating Temperature

-55°C to 155°C due to oxygen-free copper

Electroplating Material

Tin	99.9% pure
Other Metals	Lead + Antimony
Thickness	5-10 microns

General Electrical Properties

Total Conductivity	99.7% IACS
Total Resistivity:	1.738 micro-ohm cm

Conformant Standards

AS/NZS4325 Part 1; IEC France;
DIN/VDE Germany; JIS Japan;
BS United Kingdom; UL/NEMA USA

Dimensional Specification

Tooling is interchangeable between CABAC, Utilux and Burndy.

Sealed Palm

Silver solder min. melt point 180°C

Torque Recommendations

For hardware being metric 8.8 tensile grade

Thread dia.(mm)	Torque (Nm)
5	5
6	9
8	22
10	44
12	77
16	190

NOTE: Special Manufacture
CABAC Manufacturing can modify, bend and punch long palm long barrel lugs to your requirements. Contact the Cabac Sales Hotline on 133 122.

NOTE: Specially manufactured items are NOT returnable. Please ensure we fully understand your requirements.

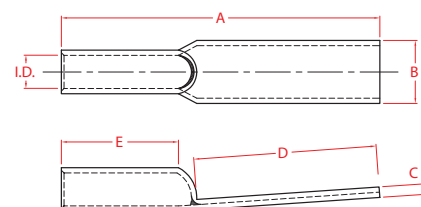

Hole Variations

